

F

PHOTO-ELECTRIC LIGHT CONTROL SERIES

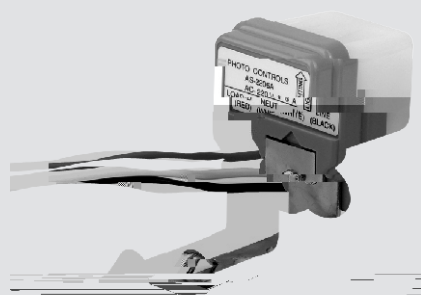

LIRRD



Electrical connection:

G

VOLTMETER & AMMETER SERIES

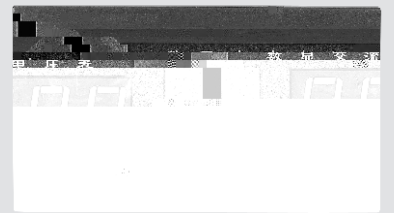
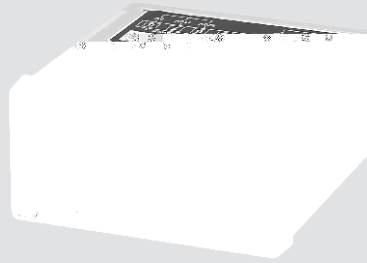

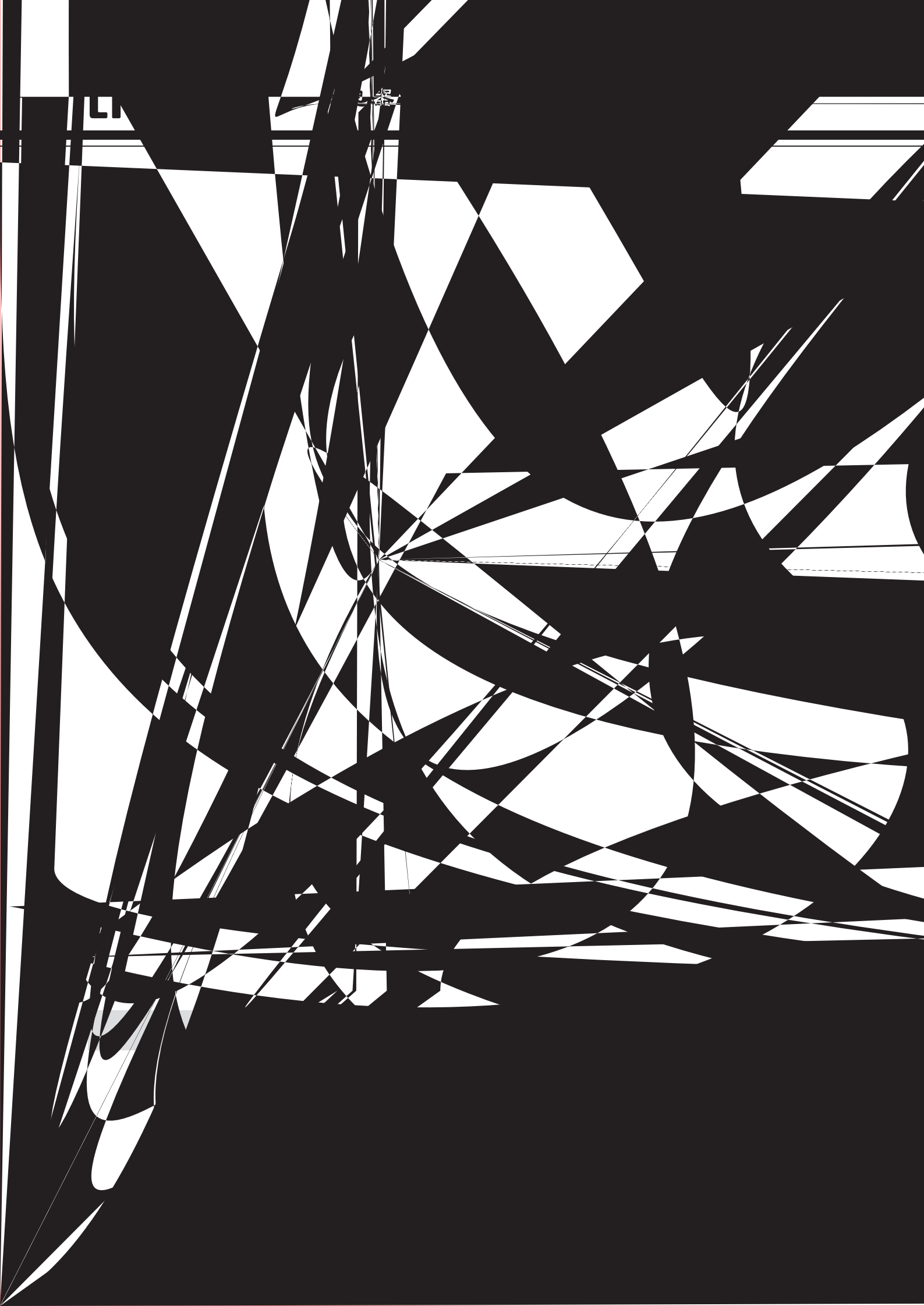

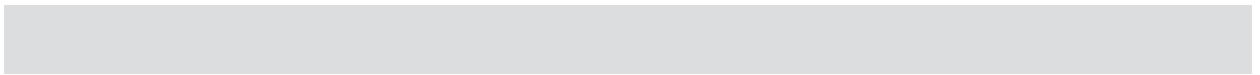



LDM4

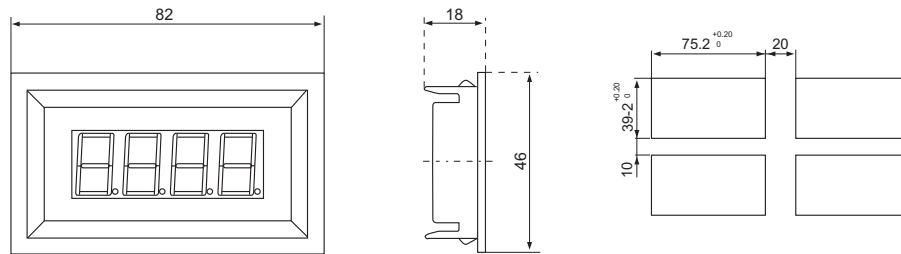

Notice for operation and storage

1	0 ~40	85%	
2			
3			
4			
5			
6			4
7	-10 ~70	60%	

- (1) Use in ambient temperature of 0 to 40 , relative humidity less than 85% R.H.
- (2) The meter calibration interval time is one year.
- (3) Avoid using instruments in an area surrounded by vibrations or shock, dust, organic corrosive materials of gas.
- (4) If the input signal with high-frequency noise, use a High-pass FILTER IN THE INPUT SIGNAL LINE.
- (5) Input wire should not be too long. If measured signal and meter is long, please use a 2-core shielded cable, and connect its outer shield to the LO side at a signal source.
- (6) If the digit meter relay is not used for a long time. Please connect power supply once every three months, not less than 4 hours each time.
- (7) Long time for storing the meter in the shade with no high light-line with temperature of -10 to 70 , and humidity less than 60% Don't contact with organic solvents or gas.